

A

A

6

5

4

3

2

1

### I-JOIST BOTTOM FLANGE FIXING

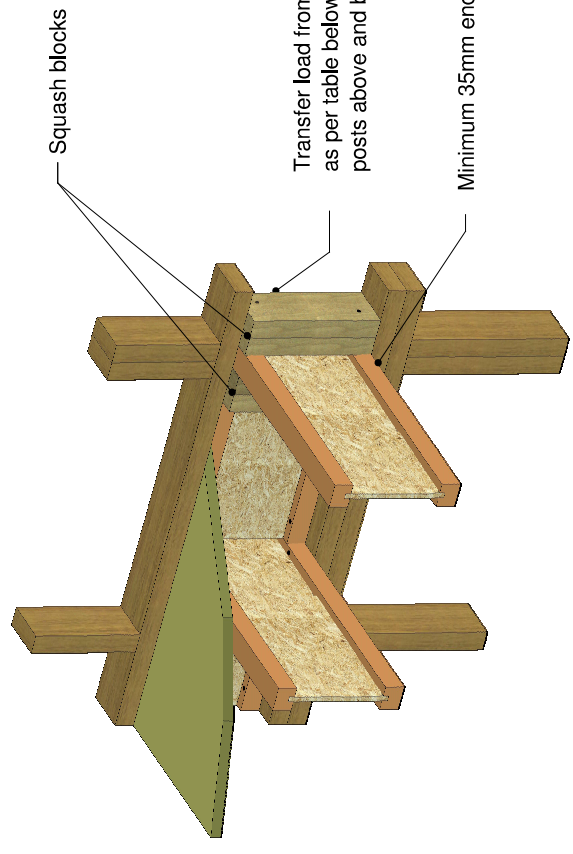

Transfer load from above to bearing below. Install squash blocks as per table below. Match bearing area and timber grade of squash blocks to posts above and below.

Minimum 35mm end bearing required for I-Joists

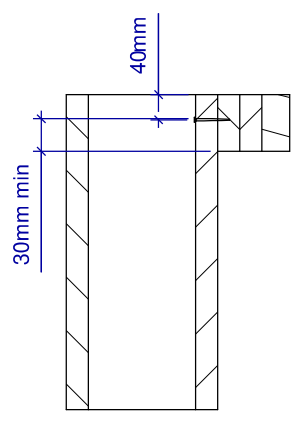
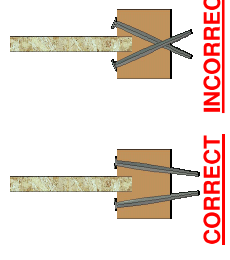

Attach I-Joist blocking to top plate with Ø3.15x65mm nails at 150mm o.c.  
 To avoid splitting the flange, start nails at least 40mm from the end.  
 Drive nails at an angle to prevent splitting of the bearing plate. (when used for shear transfer, nail to the bearing plate with the same nails as required for decking).

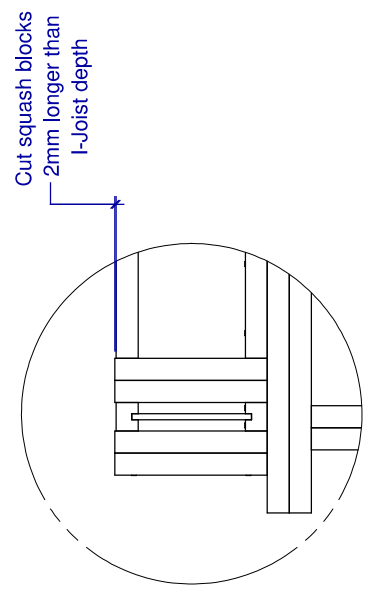

Note: Squash blocks are assumed to be in full bearing on the plate below. Fasten squash blocks to the top flange and to the top plate with one Ø3.15x65mm nail.

### JOIST END VIEW

Squash Blocks	I-Joist	Squash Blocks Cross Section (m m x m m)	Max. Factored Vertical Load per Pair of Squash Blocks (kN)	
			MGP10 wall plate bearing analysis included	
MGP10 (min,grade)	max. 400mm	35 x 90	No	Yes
		45 x 90	64	30
		45 x 140	82	39
			127	61

NOTES:		Private Confidential & Copyright This drawing is the exclusive property of Dindas Australia. Copyright & all rights reserved. You hereby agree and undertake that you will not in anyway utilize, copy reproduce or take advantage of the drawing (or any part thereof) and disclose any information to other parties without the written consent of Dindas Australia.	SIZE
1. Dimensions are in millimetres. 2. Tolerance on all dimensions to be +/- 0.5mm unless noted otherwise. 3. Written dimensions take precedence over scaled dimensions.			A4
TITLE:		SCALE	
DATE CREATED: 28/07/2020		N.T.S.	
DRAWN BY: B.S			
CHECKED BY: --			
DWG REV: --			

### DETAIL 1E

### CONCENTRATED LOADS AT STUDS OR POSTS

B

B

5

4

3

2

1

C

C

D

D