

1

2

3

4

5

6

A

A

B

B

C

C

D

D

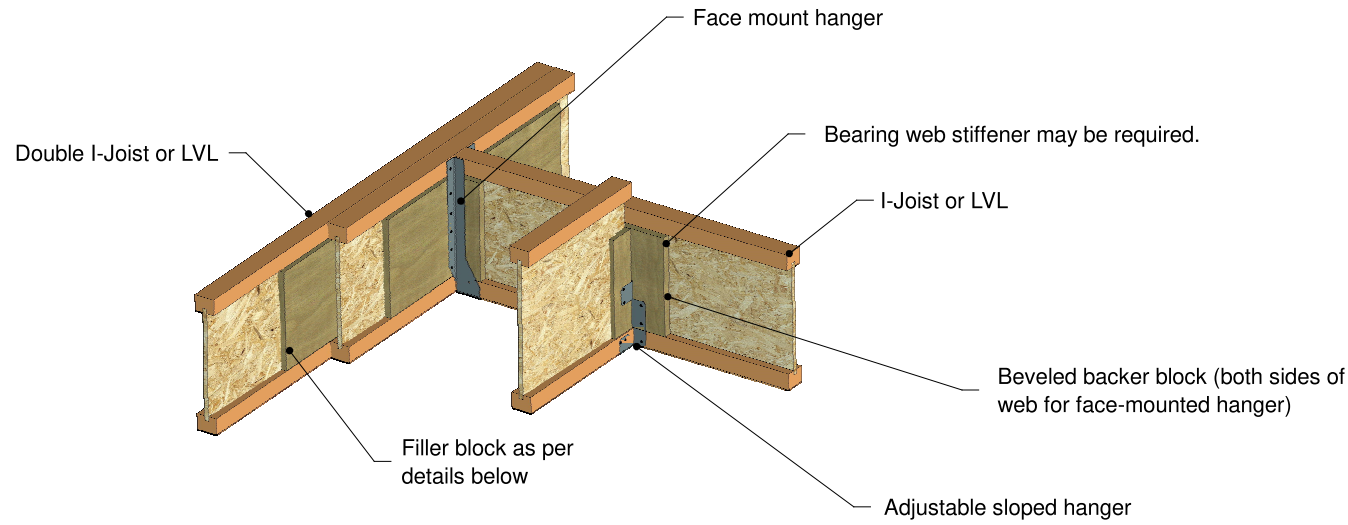

DOUBLE I-JOISTS DETAIL

- Double I-Joists may be required for frame openings, support concentrated loads, support partitions parallel to floor joists, or support any other loads which would exceed the capacity of a single I-joist. Install double I-joists when noted in the building drawings.
- Filler blocks do not function as web stiffeners. If web stiffeners are required, it is recommended to install continuous filler block and install web stiffener below filler block prior to attaching I-Joist reinforcement. Leave 6mm gap between the top of filler block and bottom of top I-Joist flange. Web stiffeners must be tight between top of bottom flange and bottom of filler block.
- Support back of I-Joist web during nailing to prevent damage to web/flange connection.
- Leave a 3mm gap between top of filler block and bottom of top I-joist flange.
- For side-loaded conditions or cantilever reinforcement, filler block is required between joists for full length of double member.
- Nail joists together with two rows of Ø3.15x65mm nails at 150mm o.c. spacing (staggered) on each side of the double I-Joist. Total of 8 nails per 3m required.
- Filler block thickness may be achieved by using multiple layers of structural wood panels.
- The maximum factored load that may be applied to one side of the double joists using this detail is 7.15 kN/m.

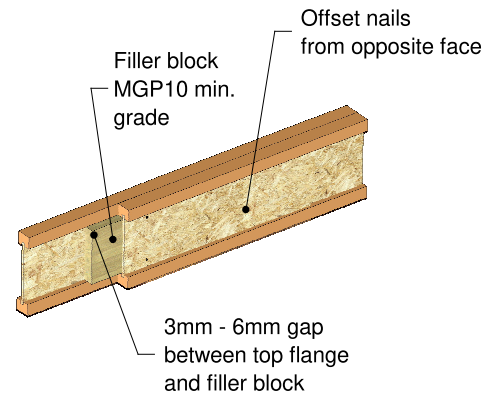

FILLER BLOCK TABLE

Joists series	Flange width (mm)	Joist depth (mm)	Net filler block size (mm x mm)
RFPI 20	45	240	35 x 150
		300	35 x 200
		360	35 x 250
RFPI 400	52	240	45 x 150
		300	45 x 200
		360	45 x 250
RFPI 70	58	240	50 x 150
		300	50 x 200
		360	50 x 250
RFPI 90	90	400	50 x 300
		300	75 x 200
		360	75 x 250
		400	75 x 300

your partner for engineered timber solutions

DINDAS AUSTRALIA
ENGINEERING DIVISION

433 Wondall Road, Tingalpa 4173, Queensland

DATE CREATED: 07/08/2020
DRAWN BY: B.S
CHECKED BY: --
DWG REV: --

TITLE:
**DETAIL 3G
ROOF OPENING HANGER CONNECTIONS**

NOTES:
1. Dimensions are in millimetres.
2. Tolerance on all dimensions to be +/- 0.5mm unless noted otherwise.
3. Written dimensions take precedence over scaled dimensions.

Private Confidential & Copyright
This drawing is the exclusive property of Dindas Australia. Copyright & all rights reserved. You hereby agree and undertake that you will not in anyway utilize, copy reproduce or take advantage of the drawing (or any part thereof) and disclose any information to other parties without the written consent of Dindas Australia.

SIZE
A4
SCALE
N.T.S

1

2

3

4

5

6