

1

2

3

4

5

6

A

A

B

B

C

C

D

D

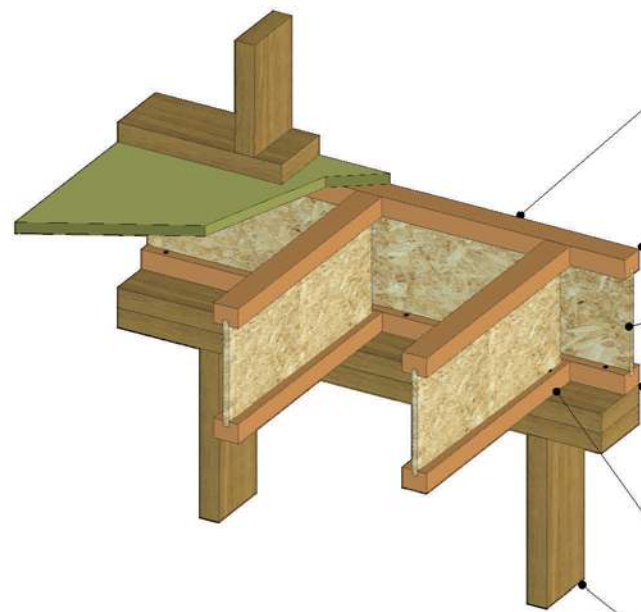

Rim I-Joist

Attach Rim I-Joist to floor joist with one Ø3.75x75mm nail at top and bottom. Nail must provide 25mm minimum penetration into floor joist. For flange widths greater than 65mm, toenails may be used.

Attach I-Joist to top plate with one Ø3.15x65mm face nail at each side of bearing. To avoid splitting the flange, install nails at least 40mm from end of joist. Nails may be driven at an angle to avoid splitting the bearing plate.

Attach Rim I-Joist to top plate with Ø3.15x65mm nails at 150mm o.c. (when used for lateral shear transfer, nail to the bearing plate with the same nails as required for decking.)

Minimum 35mm end bearing required for I-Joists

Minimum 120mm width frame to be used

I-JOIST BOTTOM FLANGE FIXING

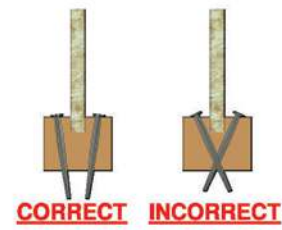

CORRECT

INCORRECT

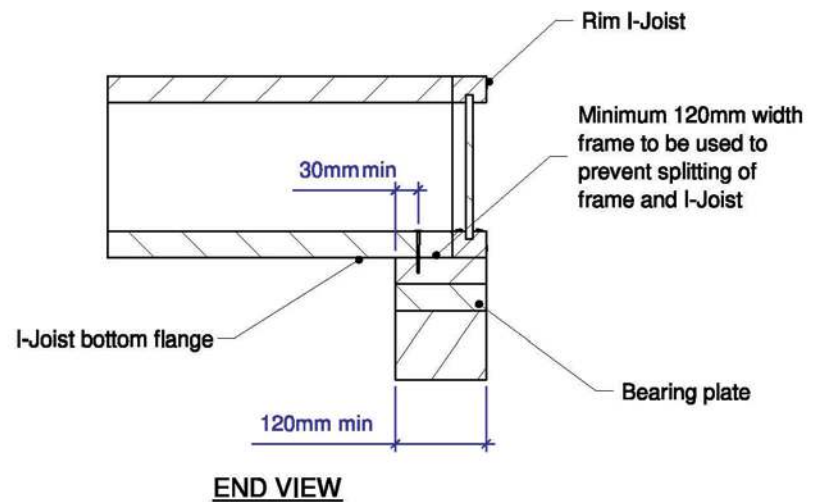

your partner for engineered timber solutions

DATE CREATED:	28/07/2020
DRAWN BY:	B.S
CHECKED BY:	--
DWG REV:	--

TITLE:

**DETAIL 1C
RIM I-JOIST AT EXTERIOR WALL**

NOTES:

1. Dimensions are in millimetres.
2. Tolerance on all dimensions to be +/- 0.5mm unless noted otherwise.
3. Written dimensions take precedence over scaled dimensions.

Private Confidential & Copyright
This drawing is the exclusive property of Dindas Australia. Copyright & all rights reserved. You hereby agree and undertake that you will not in anyway utilize, copy reproduce or take advantage of the drawing (or any part thereof) and disclose any information to other parties without the written consent of Dindas Australia.

SIZE
A4

SCALE
N.T.S

1

2

3

4

5

6